

Fig 1

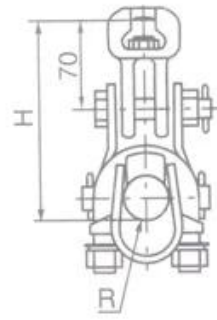

Fig 2

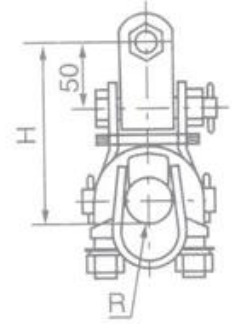

Fig 3

Part No.	Material	Dimensions (mm)			Part No.	U.T.S	Weight
		H	L	R			
XGU-1	500-700	82	180	4.0	1	40	1.4
XGU-2	701-1300	82	200	7.0		40	1.8
XGU-3	1301-2100	102	220	11.0		40	2.0
XGU-4	2101-2600	110	250	13.5		40	3.0
XGU-5	2300-3300	87	300	17		60	4.7
XGU-6	3400-4500	93	300	23		60	5.1
XGU-5A	2300-3300	157	300	17	2	60	5.7
XGU-6A	3400-4500	163	300	23		60	6.1
XGU-5B	2300-3300	137	300	17	3	60	5.4
XGU-6B	3400-4500	143	300	23		60	5.8
XGU-7B	4500-4800	146	300	26		60	6.

The dimensions and material specifications are provided for reference. The actual dimensions and material specifications may vary slightly due to manufacturing tolerances. The weight is calculated based on the dimensions and material density. The U.T.S is the ultimate tensile strength of the material.