

Fig1

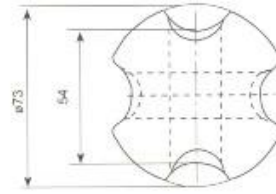
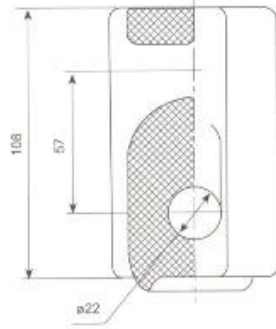

Fig2

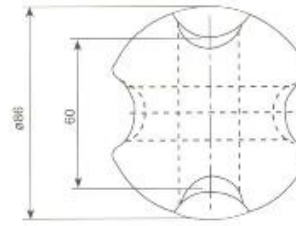
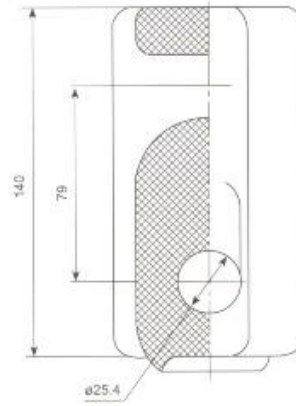

Fig3

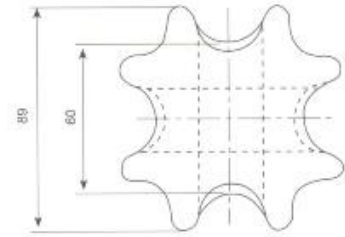
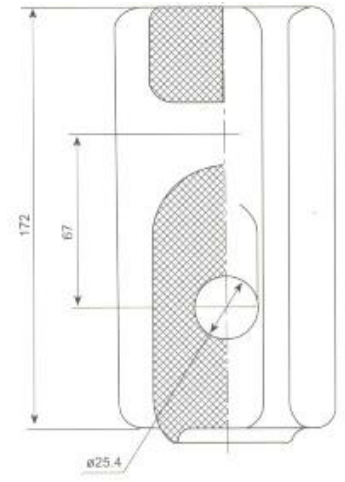

Fig4

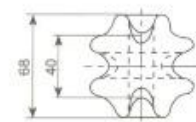
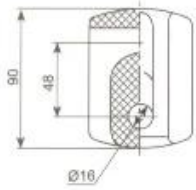

Fig5

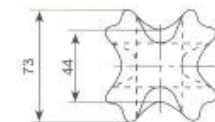
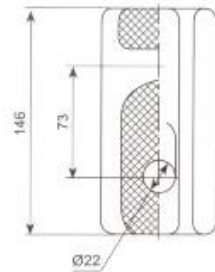

Fig6

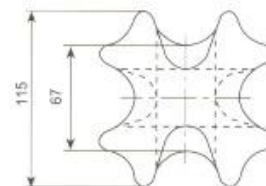
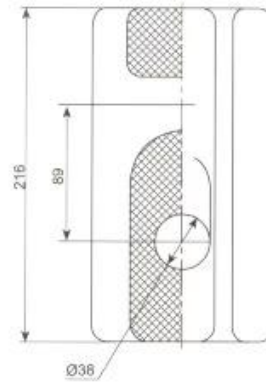

Fig7

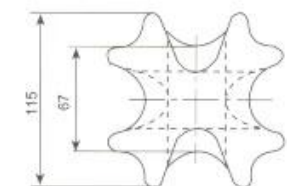
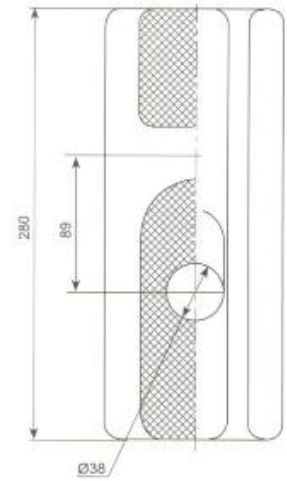

Fig8

MAIN ABMESSUNGEN UND STANDARDANFORDERUNGEN						
ANSI KLASSE	Bildnr	Leckdistanz mm	Mechanische Ausfalllast KN	Netzfrequenz-Überschlagsspannung kV		Gewicht (N)
				Trocken	Nass	
54-1	1	41	44	25	12	4.9
54-2	2	47.6	53	30	15	7.8
54-3	3	57	89	35	18	12.3
54-4	4	76	89	40	23	17.6

MAIN ABMESSUNGEN UND STANDARD-BESTIMMUNGEN

AS Typ	Art	Bildnr	Netzfrequenz nass Spannungsfestigkeit kV	Stand oder Drahtseilgröße mm	Mechanische Ausfalllast KN
GY-1	J-2.7	5	10	7 / 2.75	27
GY-2	J-7	6	15	19 / 2.00	71
GY-3	J-16	7	20	19 / 2.75	222
GY-4	J-16B	8	30	19 / 2.75	222