

Fig1

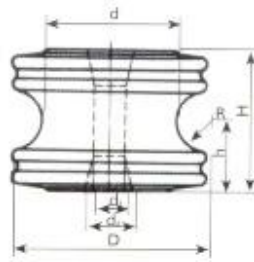

Fig2

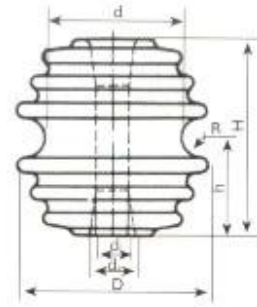

Fig3

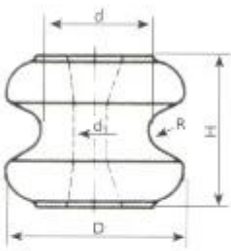

Fig4

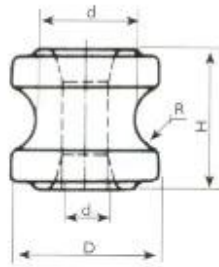

Fig5

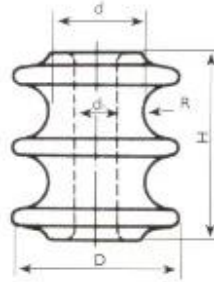

Fig6

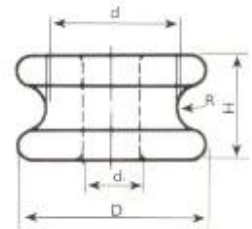

Fig7

### MAIN ABMESSUNGEN UND STANDARDANFORDERUNGEN

Katz. Nein. (Klasse ANSI)	Bildnr	Hauptabmessungen							Transversal Stärke N	Niederfrequenz Spannung kV			Gewicht kgs
		H	h	D	d	d1	d2	R		Tag Überschlag	Nasser Überschlag		
											Vertikal	Horizontal	
53-1	2	54	27	57	45	18	22	11	8900	20	8	10	2.2
53-2	1	76	38	79	45	18	24	18	13.300	25	12	15	5.4
53-3	2	81	40.5	76	45	18	24	11	17.800	25	12	15	5.9
53-4	2	76	38	105	73	18	24	16	20.000	25	12	15	11.3
53-5	3	105	52.5	102	73	18	24	11	26.700	35	18	25	11.8
R-8	7	32		57	40	17.5		7			15	918	1.3
R-6	6	80		70	40	18		7	240	12	15	1350	3.9
R-2	5	76		80	54	17.5		17.5			15	2040	5.9
R-1	5	54		57	39	17.5		11			15	918	2.4
1617	4	65		76	46	17.5		9	9000	20	9	9	3.9
1618-1	4	75		89	52	17		13	10000	20	9	9	
1618-2	4	75		89	52	17		12.5	13000	25	12	12	
1617-2	4	67		73		16		14.3					
1617-1	4	65		78		17.5		12.5					
1618-3	4	88		95		22		16					