

Fig1

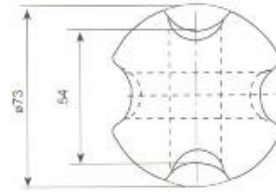
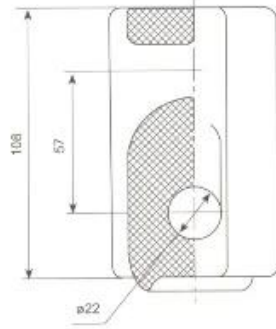

Fig2

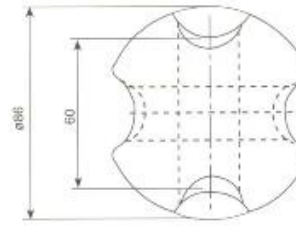
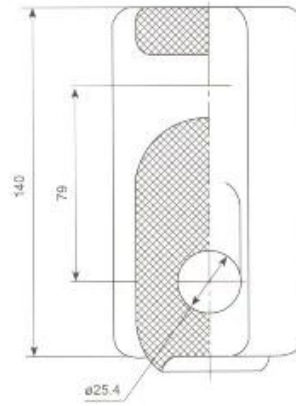

Fig3

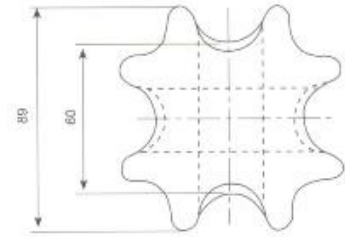
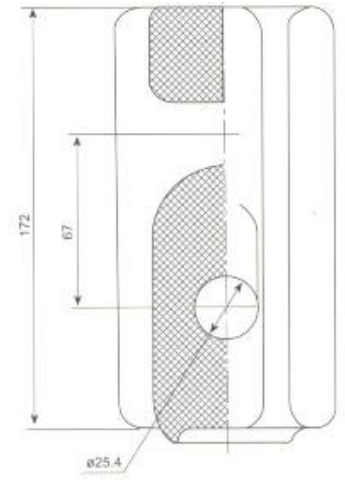

Fig4

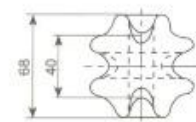
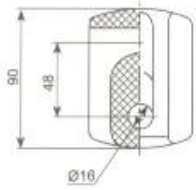

Fig5

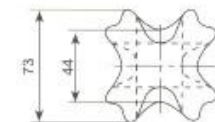
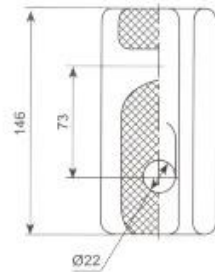

Fig6

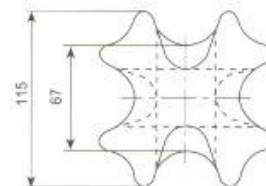
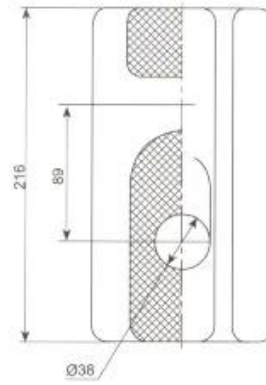

Fig7

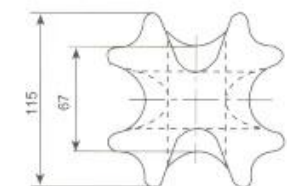
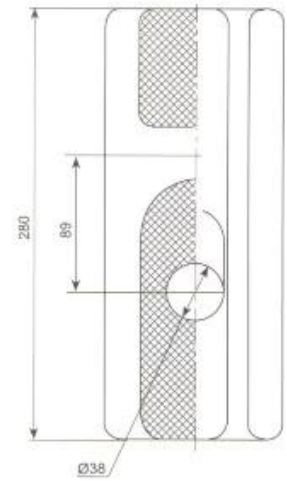

Fig8

PRINCIPAL DIMENSIONES Y DATOS ESTÁNDAR

ANSI CLASE	Fig.No	Distancia de fuga mm	Carga mecánica fallida KN	Voltaje de flashover de frecuencia de potencia kV		Peso (NORTE)
				Seco	Mojado	
54-1	1	41	44	25	12	4.9
54-2	2	47.6	53	30	15	7.8
54-3	3	57	89	35	18	12.3
54-4	4	76	89	40	23	17.6

PRINCIPALES DIMENSIONES Y DATOS ESTÁNDAR

Tipo AS	Tipo	Fig.No	Frecuencia de potencia mojada Tensión soportada kV	Tamaño del cable o soporte mm	Carga mecánica fallida KN
GY-1	J-2.7	5	10	7 / 2.75	27
GY-2	J-7	6	15	19 / 2.00	71
GY-3	J-16	7	20	19 / 2.75	222
GY-4	J-16B	8	30	19 / 2.75	222