

Fig1

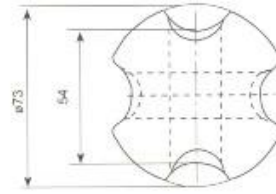
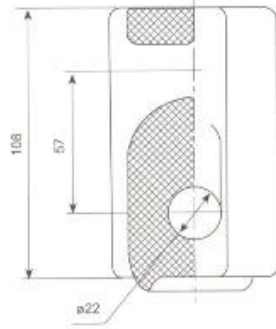

Fig2

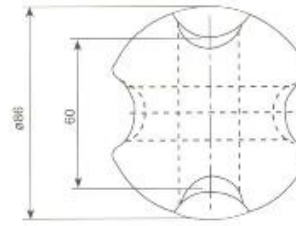
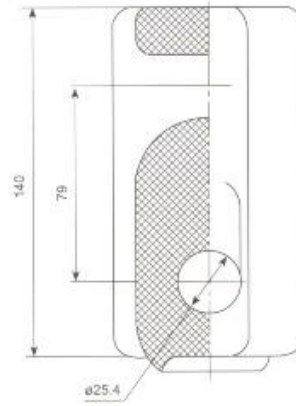

Fig3

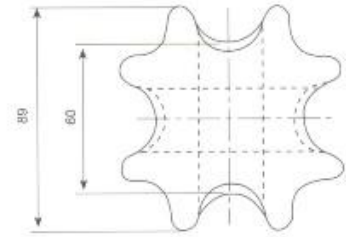
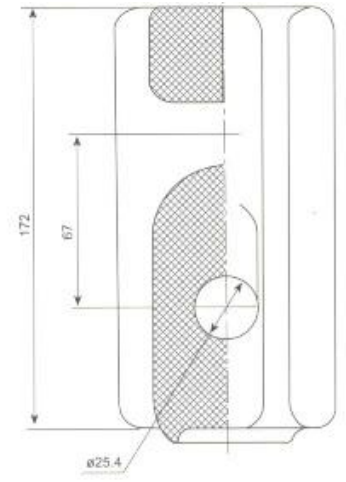

Fig4

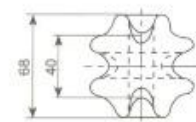
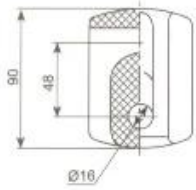

Fig5

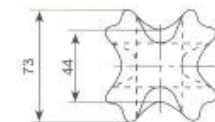
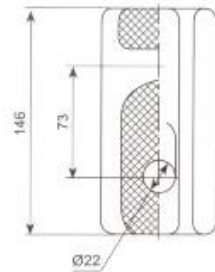

Fig6

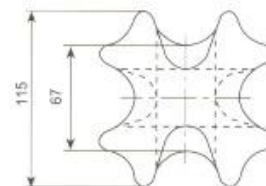
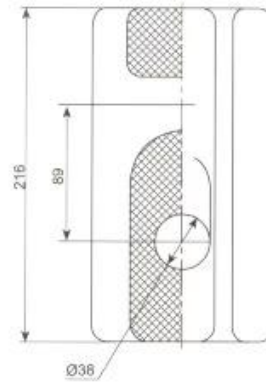

Fig7

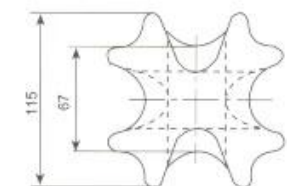
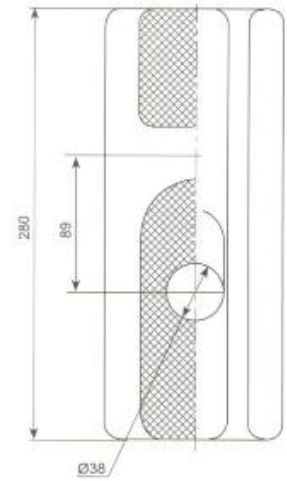

Fig8

PRINCIPALE DIMENSIONS ET MENTIONS STANDARD

ANSI CLASSE	Fig.No	Distance de fuite mm	Charge défailante mécanique KN	Tension d'amorçage à fréquence industrielle		Poids (N)
				Sec	Humide	
54-1	1	41	44	25	12	4,9
54-2	2	47,6	53	30	15	7.8
54-3	3	57	89	35	18	12,3
54-4	4	76	89	40	23	17,6

DIMENSIONS PRINCIPALES ET MENTIONS STANDARD

Type d'AS	Type	Fig.No	Puissance-fréquence humide Tension de tenue kV	Taille du support ou du câble mm	Charge défailante mécanique KN
GY-1	J-2.7	5	dix	7 / 2,75	27
GY-2	J-7	6	15	19 / 2,00	71
GY-3	J-16	7	20	19 / 2,75	222
GY-4	J-16B	8	30	19 / 2,75	222