

Fig1

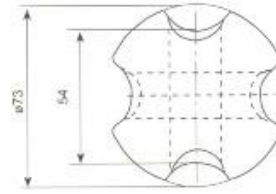
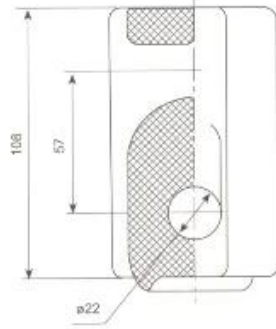

Fig2

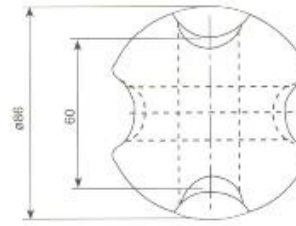
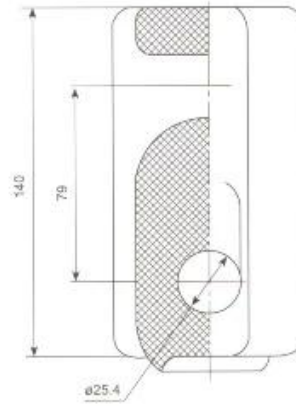

Fig3

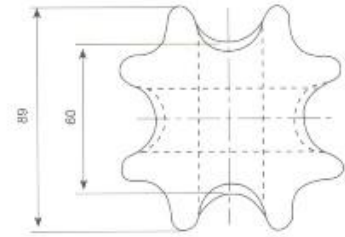
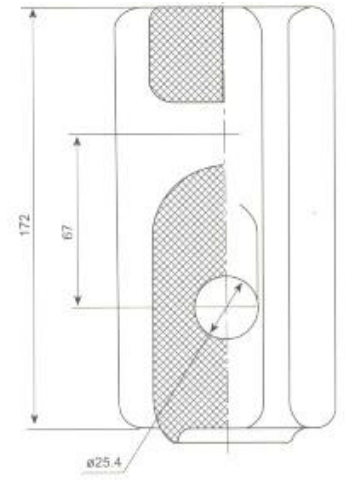

Fig4

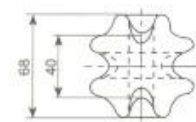
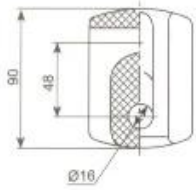

Fig5

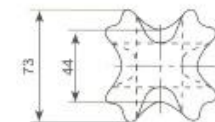
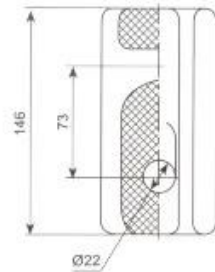

Fig6

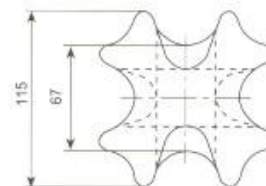
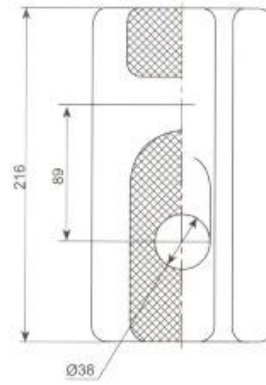

Fig7

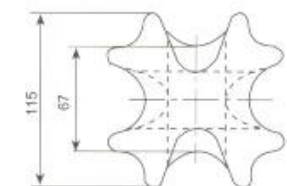
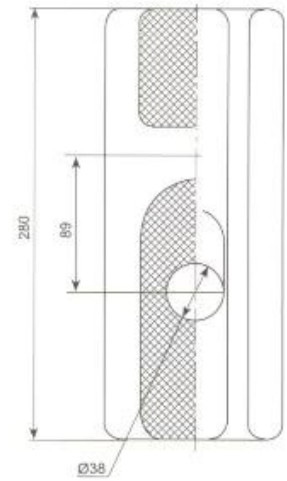

Fig8

PRINCIPALE DIMENSIONI E PARTICOLARI STANDARD

ANSI CLASSE	Fig.No	Distanza di dispersione mm	Carico meccanico difettoso KN	Tensione del flashover della frequenza di alimentazione kV		Peso (N)
				Asciutto	Bagnato	
54-1	1	41	44	25	12	4.9
54-2	2	47.6	53	30	15	7.8
54-3	3	57	89	35	18	12.3
54-4	4	76	89	40	23	17.6

DIMENSIONI PRINCIPALI E PARTICOLARI STANDARD

AS tipo	genere	Fig.No	Frequenza di potenza bagnata resistere alla tensione kV	Dimensioni del cavalletto o del cavo mm	Carico meccanico difettoso KN
GY-1	J-2.7	5	10	7 / 2,75	27
GY-2	J-7	6	15	19 / 2.00	71
GY-3	J-16	7	20	19 / 2,75	222
GY-4	J-16B	8	30	19 / 2,75	222