

Fig1

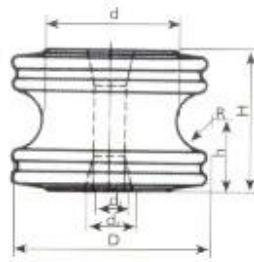

Fig2

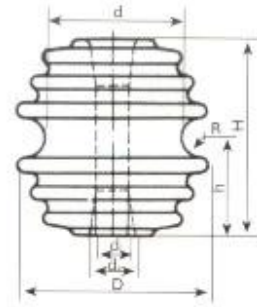

Fig3

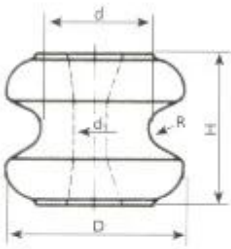

Fig4

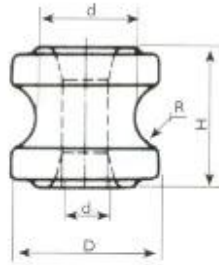

Fig5

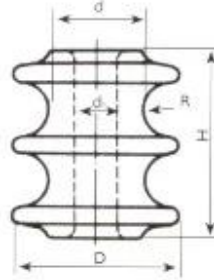

Fig6

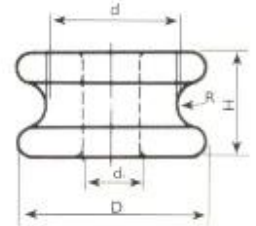

Fig7

□□ □□ □ □□

□□□. □□. (□□□ ANSI)	Fig.No	□□ □□							□□ □ □	□□ □□ □□ kV			□□ kgs
		H	h	□	□	d1	d2	□□ □□		□□ □□ □□	□□		
53-1	2	54	27	57 □	45	18	22	11	8900	20	8	10	2.2
53-2	1	76	38 □	79	45	18	24	18	13,300	25 □	12	15 □	5.4
53-3	2	81	40.5	76	45	18	24	11	17,800	25 □	12	15 □	5.9
53-4	2	76	38 □	105	73	18	24	16	20,000	25 □	12	15 □	11.3
53-5	□	105	52.5	102	73	18	24	11	26,700	35 □	18	25 □	11.8
R-8	7	32		57 □	40	17.5		7			15 □	918	1.3
R-6	6	80		70	40	18		7	240	12	15 □	1350	3.9
R-2	5	76		80	54	17.5		17.5			15 □	2040 □	5.9
R-1	5	54		57 □	39 □	17.5		11			15 □	918	2.4
1617 □	4	65		76	46	17.5		9	9000	20	9	9	3.9
1618-1	4	75		89	52	17		13	10000	20	9	9	
1618-2	4	75		89	52	17		12.5	13000	25 □	12	12	
1617-2	4	67		73		16		14.3					
1617-1	4	65		78		17.5		12.5					
1618-3	4	88		95		22		16					