

Fig1

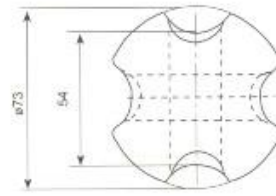
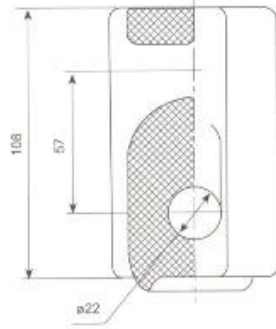

Fig2

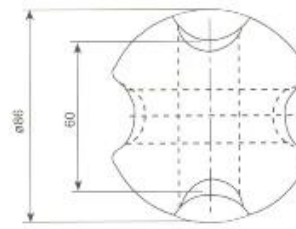
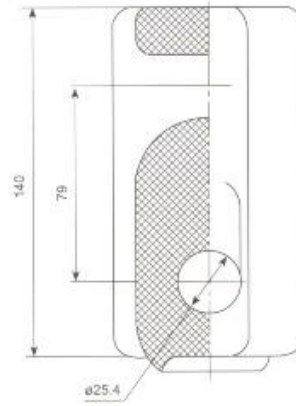

Fig3

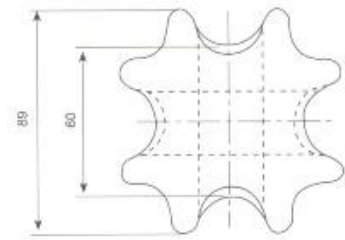
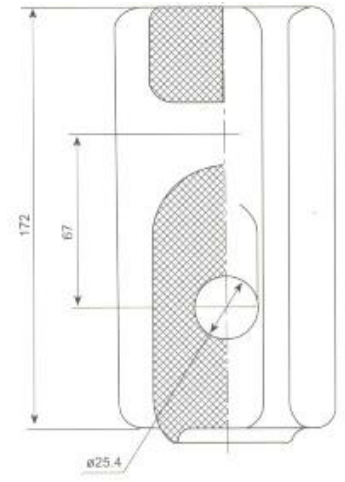

Fig4

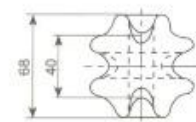
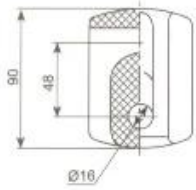

Fig5

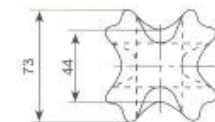
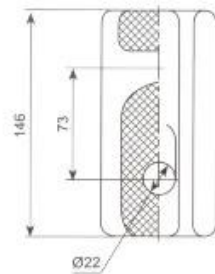

Fig6

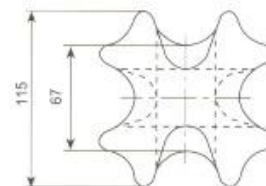
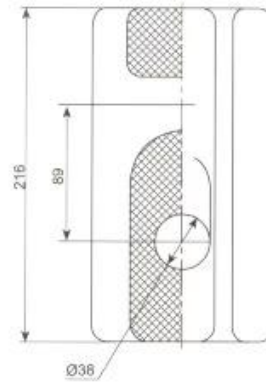

Fig7

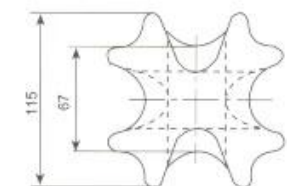
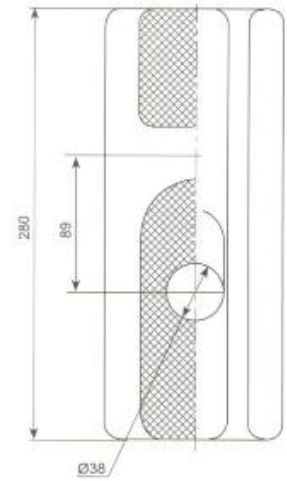

Fig8

MAIN DIMENSTIONS AND STANDARD PARTICULARS

ANSI CLASS	Fig.No	Leakage distance mm	Mechanical failing load KN	Power-frequency flashover voltage kV		Weight (N)
				Dry	Wet	
54-1	1	41	44	25	12	4.9
54-2	2	47.6	53	30	15	7.8
54-3	3	57	89	35	18	12.3
54-4	4	76	89	40	23	17.6

MAIN DIMENSTIONS AND STANDARD PARTICULARS

AS Type	Type	Fig.No	Power-frequency wet withstand voltage kV	Stand or wire rope size mm	Mechanical failing load KN
GY-1	J-2.7	5	10	7/2.75	27
GY-2	J-7	6	15	19/2.00	71
GY-3	J-16	7	20	19/2.75	222
GY-4	J-16B	8	30	19/2.75	222