

Fig1

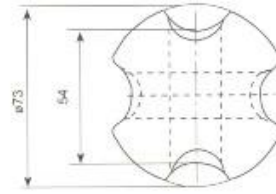
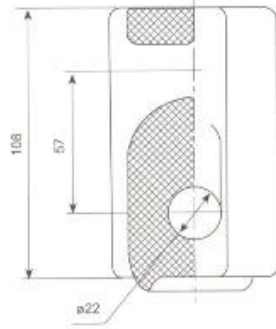

Fig2

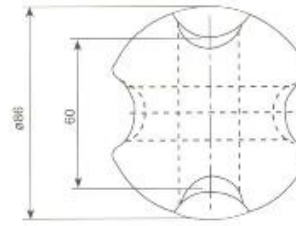
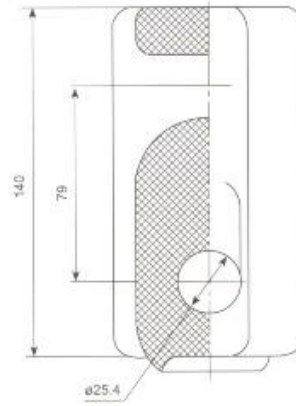

Fig3

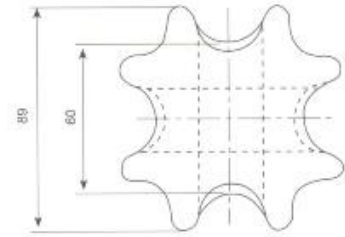
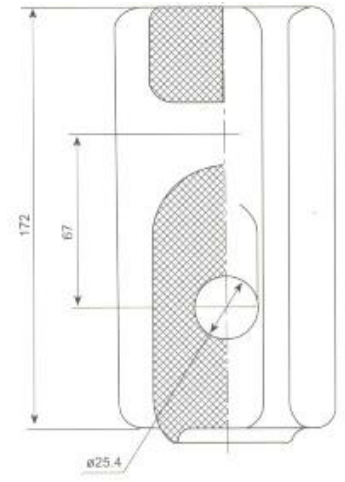

Fig4

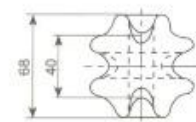
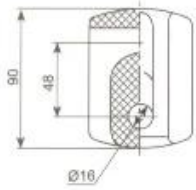

Fig5

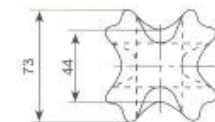
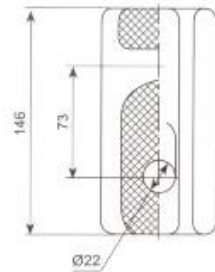

Fig6

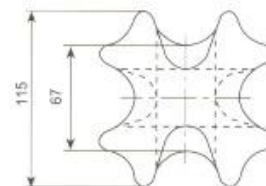
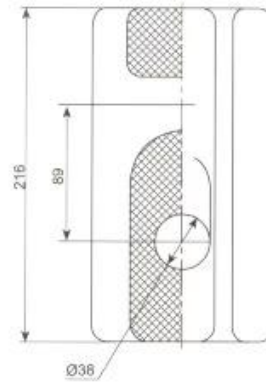

Fig7

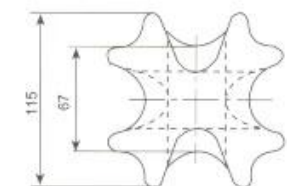
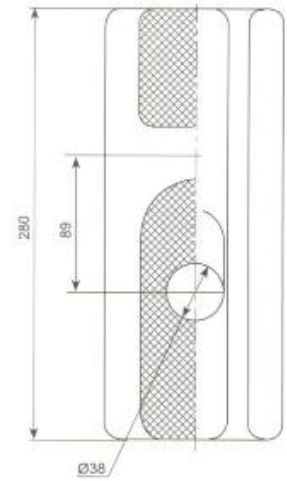

Fig8

A PRINCIPAL DIMENSÕES E PARTÍCULAS PADRÃO

| ANSI CLASSE | Fig.No | Distância de fuga milímetros | Carga de falha mecânica KN | Tensão de flashover de frequência de energia kV | | Peso (N) |
|-------------|--------|------------------------------|----------------------------|---|---------|----------|
| | | | | Seco | Molhado | |
| 54-1 | 1 | 41 | 44 | 25 | 12 | 4,9 |
| 54-2 | 2 | 47,6 | 53 | 30 | 15 | 7,8 |
| 54-3 | 3 | 57 | 89 | 35 | 18 | 12,3 |
| 54-4 | 4 | 76 | 89 | 40 | 23 | 17,6 |

PRINCIPAIS DIMENSÕES E PARTÍCULAS PADRÃO

| Tipo AS | Tipo | Fig.No | Frequência de energia molhada tensão suportável kV | Suporte ou tamanho do cabo de aço milímetros | Carga de falha mecânica KN |
|---------|-------|--------|--|--|----------------------------|
| GY-1 | J-2.7 | 5 | 10 | 7 / 2,75 | 27 |
| GY-2 | J-7 | 6 | 15 | 19 / 2,00 | 71 |
| GY-3 | J-16 | 7 | 20 | 19 / 2,75 | 222 |
| GY-4 | J-16B | 8 | 30 | 19 / 2,75 | 222 |