

Fig1

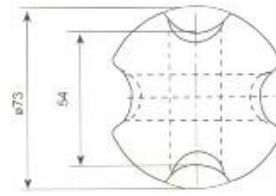
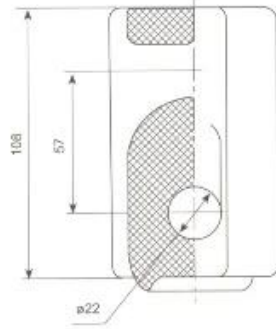

Fig2

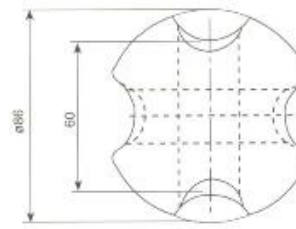
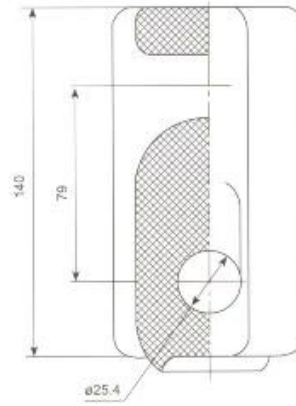

Fig3

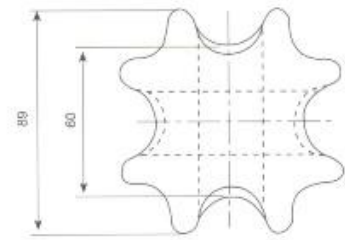
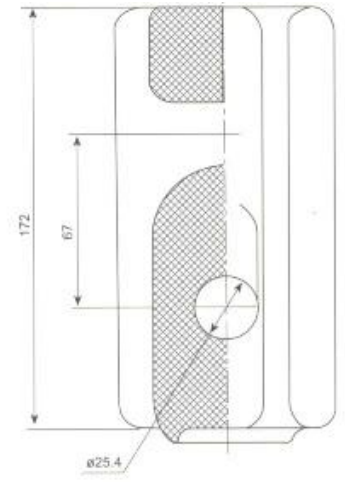

Fig4

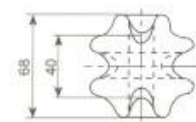
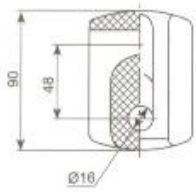

Fig5

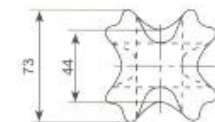
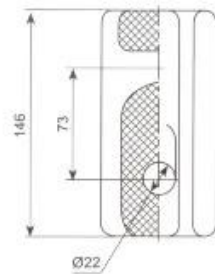

Fig6

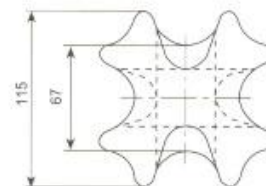
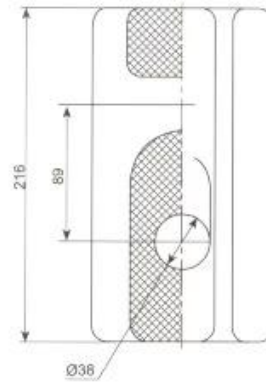

Fig7

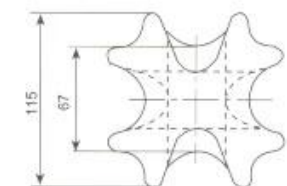
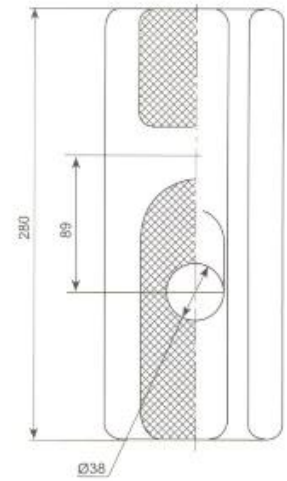

Fig8

ANA BOYUTLAR VE STANDART ÖZELLİKLER

ANSI SINIF	Fig.No	Kaçak mesafesi aa	Mekanik arıza yüklemesi KN	Güç frekansı flashover voltajı kV		Ağırlık (K)
				Kuru	Islak	
54-1	1	41	44	25	12	4.9
54-2	2	47.6	53	30	15	7.8
54-3	3	57	89	35	18	12.3
54-4	4	76	89	40	23	17.6

ANA DÜZENLEMELER VE STANDART ÖZELLİKLER

AS Türü	tip	Fig.No	Güç frekansı ıslak dayanma gerilimi kV	Stand veya tel halat boyutu aa	Mekanik arıza yüklemesi KN
GY-1	J-2.7	5	10	7 / 2.75	27
GY-2	J-7	6	15	19 / 2.00	71
GY-3	J-16	7	20	19 / 2.75	222
GY-4	J-16B	8	30	19 / 2.75	222